

CUSTOM CODE

7

STANDARD CASE PRICE

Oak	Maple	Cherry/Qsawn
\$2745	\$3105	\$3325

PREMIUM FINISH PRICE

\$ 15 Distressing
 \$ 270 Paint, Passages, Glaze, or Antique Detailing
 \$ 420 Combination, Glaze w/Olde World or Weathered

DIMENSION INCREASE PRICE

Do not include decrease inches to calculate price.

2"	4"	6"	8"	10"	12"	14"	16"	18"	20"
\$360	\$405	\$450	\$510	\$570	\$630	\$690	\$750	\$810	\$870

STANDARD DIMENSIONS & CAPABILITIES

Minimum	70H	24.5ATW
Standard	80H	30.0625ATW
Maximum	96H*	42ATW

* Refer to important Custom Notes below.

OPENING HEIGHTS BY STYLE

	06	11	17	20	33	44	51	54	65
A	14.25	14.25	14.25	14.25	12.25	13.25	13.25	14.25	14.25
B	6.25	6.25	6.25	6.25	6.25	6.25	6.25	6.25	6.25
C	47.25	45.5	48	47.25	46.75	46.75	46.75	47	48

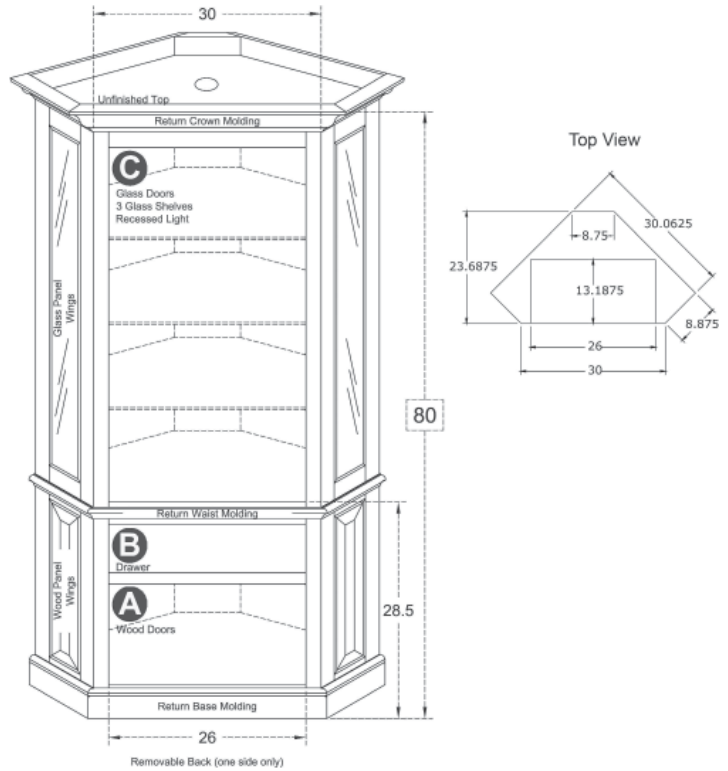

Exterior View by Style Standard size with molding on: 1 side | 2 sides



CC0621
31.875W



CC1121
32.8125W



CC1721
31.6875W



CC2021
32.25W



CC3321
33.125W

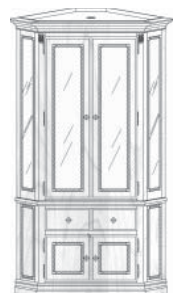

CC4421
33.125W



CC5121
33.125W



CC5421
32.875W

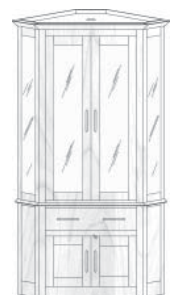

CC6521
32.1875W