

**CUSTOM CODE**

9

**STANDARD CASE PRICE**

Oak	Maple	Cherry/Qsawn
\$3910	\$4505	\$4965

**PREMIUM FINISH PRICE**

\$ 15 Distressing  
 \$ 360 Paint, Passages, Glaze, or Antique Detailing  
 \$ 540 Combination, Glaze w/Olde World or Weathered

**DIMENSION INCREASE PRICE**

Do not include decrease inches to calculate price.

2"	4"	6"	8"	10"	12"	14"	16"	18"	20"
\$585	\$645	\$705	\$765	\$825	\$885	\$945	\$1005	\$1065	\$1125

**STANDARD DIMENSIONS & CAPABILITIES**

Minimum	56H	47.9375ATW
Standard	71.25H	52ATW
Maximum	75H	54ATW

**OPENING HEIGHTS BY STYLE**

	06	11	17	20	33	44	51	54	65
A	22.5	22	22.5	22	20.5	21	21	22	22.5
B	40	39	40	39	40	40	40	40	40.5
C	22.5	22	22.5	22	20.5	21	21	22	22.5
D	22.5	22	22.5	22	20.5	21	21	22	22.5

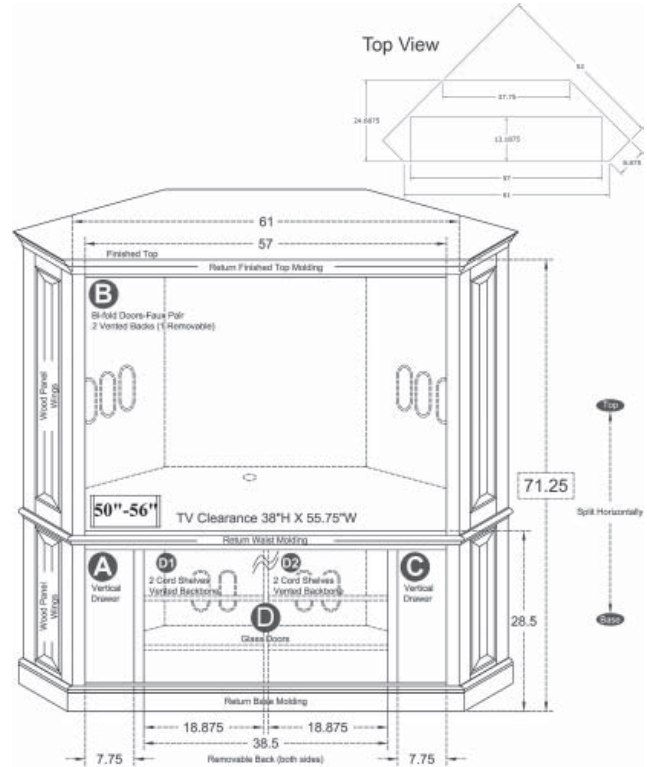

**Exterior View by Style** Standard size with molding on: 1 side | 2 sides



**CC06623**  
53.625W

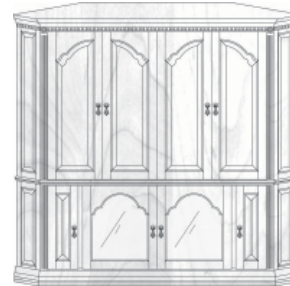

**CC11623**  
53.625W

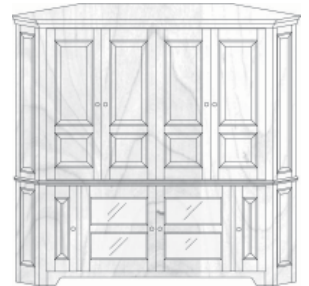

**CC17623**  
53.625W

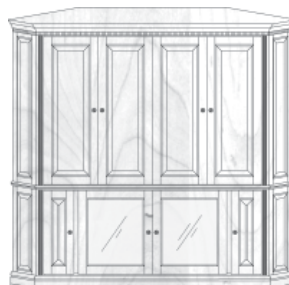

**CC20623**  
53.625W

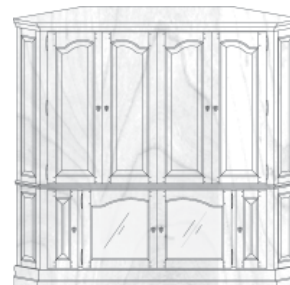

**CC33623**  
53.625W

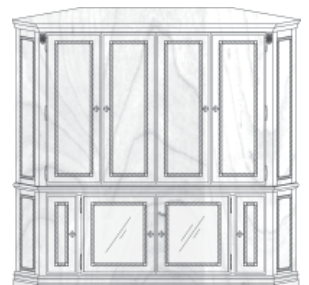

**CC44623**  
53.625W

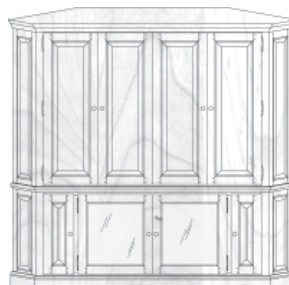

**CC51623**  
53.625W



**CC54623**  
53.625W



**CC65623**  
53.25W