

**CUSTOM CODE**

5

**STANDARD CASE PRICE**

Oak	Maple	Cherry/Qsawn
\$1040	\$1185	\$1245

**PREMIUM FINISH PRICE**

\$ 15 Distressing  
 \$ 195 Paint, Passages, Glaze, or Antique Detailing  
 \$ 300 Combination, Glaze w/Olde World or Weathered

**DIMENSION INCREASE PRICE**

Do not include decrease inches to calculate price.

2"	4"	6"	8"	10"	12"	14"	16"	18"	20"
\$240	\$285	\$330	\$390	\$465	\$540	\$615	\$675	\$735	\$795

**STANDARD DIMENSIONS & CAPABILITIES**

<b>Minimum</b>	14H	30ATW
<b>Standard</b>	16H	43.1875ATW
<b>Maximum</b>	24.5H	52ATW

**OPENING HEIGHTS BY STYLE**

	06	11	17	20	33	44	51	54	65
A	7.75	4.375	8.5	10.25	9.75	9.75	9.75	10	11

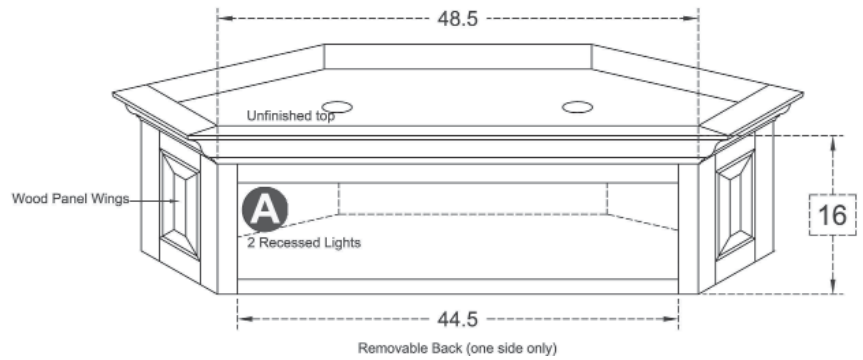
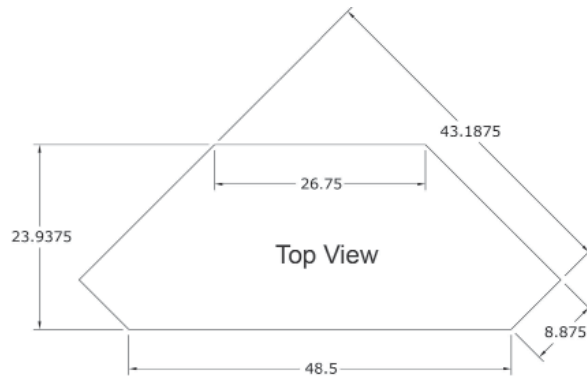

**Exterior View by Style** Standard size with molding on: 1 side | 2 sides



**CC06805**  
45W



**CC11805**  
45.9375W



**CC17805**  
44.8125W



**CC20805**  
45.375W



**CC33805**  
46.25W



**CC44805**  
46.25W



**CC51805**  
46.25W



**CC54805**  
46W



**CC65805**  
45.3125W