

CUSTOM CODE

9

STANDARD CASE PRICE

	Oak	Maple	Cherry/Qsawn
W	\$3640	\$4225	\$4490
E	\$4175	\$4790	\$5060

PREMIUM FINISH PRICE

\$ 15 Distressing
 \$ 360 Paint, Passages, Glaze, or Antique Detailing
 \$ 540 Combination, Glaze w/Olde World or Weathered

DIMENSION INCREASE PRICE

Do not include decrease inches to calculate price.

2"	4"	6"	8"	10"	12"	14"	16"	18"	20"
\$585	\$645	\$705	\$765	\$825	\$885	\$945	\$1005	\$1065	\$1125

STANDARD DIMENSIONS & CAPABILITIES

Minimum	70H	40.4375ATW
Standard	80H	40.4375ATW
Maximum	96H	40.4375ATW

OPENING HEIGHTS BY STYLE

	06	11	17	20	33	44	51	54	65
A	25.25	24.75	25.25	24.75	23.25	23.75	23.75	24.75	25.25
A1	19	18.5	19	18.5	17	17.5	17.5	18.5	19
A2	5.5	5.5	5.5	5.5	5.5	5.5	5.5	5.5	5.5
A3	19.75	19.25	19.75	19.25	17.75	18.25	18.25	19.25	19.75
B	44.5	42.75	45.25	44.5	44	44	44	44.25	45.25

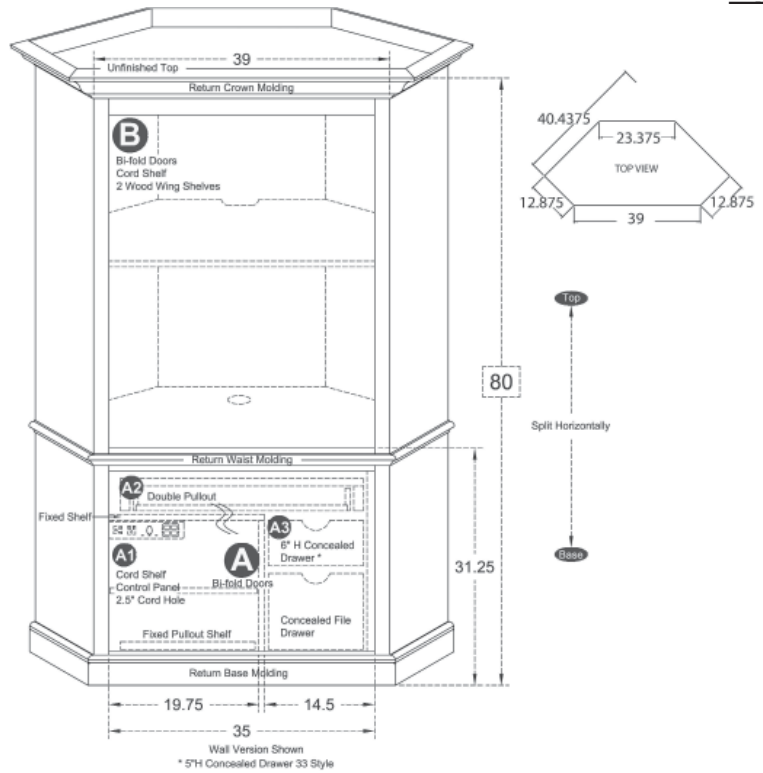

Exterior View by Style Standard size with molding on: 1 side | 2 sides



HO0690
42.25W



HO1190
43.1875W

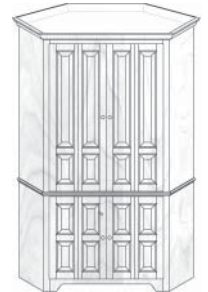

HO1790
42.0625W



HO2090
42.625W

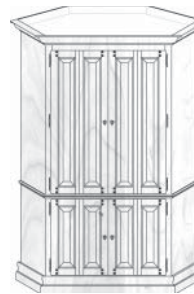

HO3390
43.5W



HO4490
43.5W



HO5190
43.5W



HO5490
43.25W

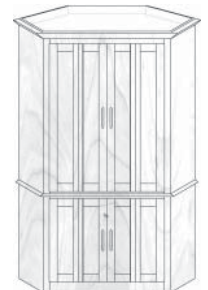

HO6590
42.5625W